

Mill Creek North Townhomes

1672 Garden Grove Court,
Jacksonville, FL 32211
904-483-9099

Amenities

Innovative multi-family homes with inspired amenities.

What's nearby

Located in the beautiful city of Jacksonville, FL.

- | | |
|-----------------------------|-------------------------------------|
| Walmart Supercenter | Publix Super Market at Dames Pointe |
| Walmart Neighborhood Market | Pretzel Twister |
| Publix Super Market Plaza | Walmart Bakery |
| Panera Bread | First Coast Cookies |
| Cafe Veneto | Goddess Food Factory |
| Dunkin' | Flour Power - Tina's Cakes & More |

Lincoln

3 bd . 2 ba . 1 half ba . 1,707 ft²

Truman

3 bd . 2 ba . 1 half ba . 1,782 ft²

Lincoln

3 bd . 2 ba . 1 half ba . 1,707 ft²

1st Floor

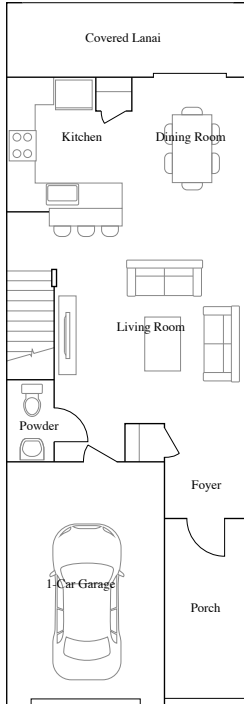

2nd Floor

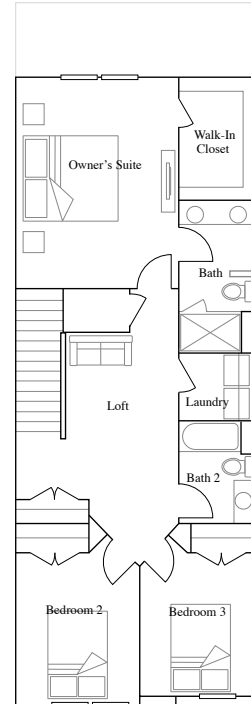

Available Exteriors



Exterior A



Exterior B

Truman

3 bd . 2 ba . 1 half ba . 1,782 ft²

1st Floor

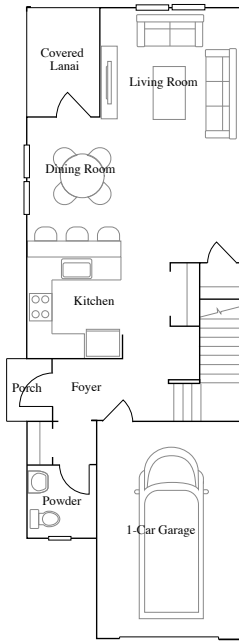

2nd Floor

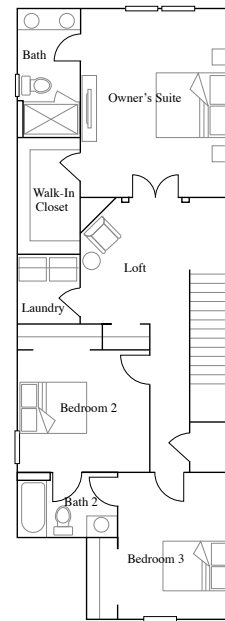

Available Exteriors



Exterior A



Exterior B

Everything included

See all you can enjoy when everything's included

Kitchen

Frigidaire® stainless steel appliance package includes a range cooktop with a built-in microwave and refrigerator

The undermount stainless steel sink pairs with a designer-selected faucet with pull-out spray

Durable and stylish quartz countertops grace the kitchen and center island

Frigidaire® stainless steel range

Frigidaire®; stainless steel microwave oven

Frigidaire® stainless steel side-by-side refrigerator with water and ice dispenser

Quartz countertops

Amerisink® stainless steel single-basin sink

Stainless steel faucet with pull-down spray

42" recessed panel cabinetry

LED recessed lighting

ENERGY STAR® dishwasher

Owners Suite

Shower and bathtubs with 12"x24" wall tile surround

Walk-in closet with mesh shelving

Quartz countertops

Plate-glass vanity mirror in all bathrooms (per plan)

Moen® bath fixtures and faucets

Double sinks at vanity

Walk-in shower with framed glass enclosure

Elongated comfort-height toilets with soft-close lids

Secondary Bathroom

Shower and bathtubs with 12"x24" wall tile surround

Quartz countertops

Plate-glass vanity mirror in all bathrooms (per plan)

Water-saving elongated toilet with soft-close lids

Moen® bath fixtures and faucets

Shower and bathtub combination with tile surround

Laundry

Wire-mesh shelving

Tile flooring

Interior

Ceramic tile flooring runs throughout the living room, kitchen and bathrooms

9' ceilings on first floor

Tile flooring in kitchen and bathrooms

Exterior

Sherwin-Williams® exterior paint

Relaxing screened and covered lanai

Low-maintenance vinyl windows

Insulated fiberglass six-panel front door

Eco-friendly landscape package

Full yard programmable irrigation system

Two exterior hose bibs

LED recessed lighting

R-30 ceiling insulation

A screened lanai extends the home for outdoor entertainment and activities (per plan)

Connectivity

Wifi heat mapping (engineering)

Smart front door lock

Honeywell Home T6 Pro Z-Wave - smart thermostat

Ring Video Doorbell Pro

Energy Efficiency

Exterior air filtration damper

Programmable thermostats

Energy-efficient low-E windows

R-30 ceiling insulation

Energy-efficient water heater tank

Services

myLennar (online assistant to help through the homebuying process)

Lennar Mortgage (financial services)

Lennar Title (title services)

Lennar Insurance Agency (home insurance)

Limited one-year warranty on workmanship

Dedicated Customer Care service and program

24-hour emergency customer service

Availability

Find the home that's right for you.

Prices and availability as of April 10, 2024. All subject to change.

Homesite	Price	Details	Plan	Address
0062	Priced at \$334,494	3 bd . 2 ba . 1 half ba . 1,707 ft²	Lincoln	1674 GARDEN GROVE CT
0057	Priced at \$349,494	3 bd . 2 ba . 1 half ba . 1,782 ft²	Truman	1688 GARDEN GROVE CT

Nearby schools

Public schools zoned for this community

Merrill Road Elementary School

Public PK, K-2

Duval County Public Schools

B-

Overall Niche Grade

[View on Niche.com](#)

Arlington Middle School

Public 6-8

Duval County Public Schools

C-

Overall Niche Grade

[View on Niche.com](#)

Terry Parker High School

Public 9-12

Duval County Public Schools

C

Overall Niche Grade

[View on Niche.com](#)

Plan your visit

Community information

Location

1672 Garden Grove Court
Jacksonville, FL 32211

Hours

By appointment only.

Phone

904-483-9099

HOA & Tax information

Aprox monthly HOA fees - \$212

Approximate tax rate - 1.61%

Why Lennar

We take pride in providing the easiest way to buy a home.

Where you want to live

We understand how you want to live, and create homes in communities in some of the most sought-after cities across the county.

Something for everyone

We understand homebuilding, and people. Our homes cater to a variety of lifestyles, and reflect the culture and region in which they're built.

A simpler way to buy

Our family of companies can assist you with your mortgage, title and insurance needs - allowing you to save time and money.

Features, amenities, floor plans, elevations, and designs vary and are subject to changes or substitution without notice. Items shown are artist's renderings and may contain options that are not standard on all models or not included in the purchase price. Availability may vary. Sq. ft. and dimensions are estimated; actual sq. ft. and dimensions will differ. Garage/bay sizes may vary from home to home and may not accommodate all vehicles. This is not an offer in states where prior registration is required. Void where prohibited by law. Copyright © 2021 Lennar Corporation. Lennar and the Lennar logo are U.S. registered service marks or service marks of Lennar Corporation and/or its subsidiaries. Seller's Broker: Lennar Realty, Inc. Construction License(s): CGC1518166. Date 1/22



Copyright © 2023 Lennar Corporation. All right reserved.

Printed on 4/10/2024